

PRV05 light commercial

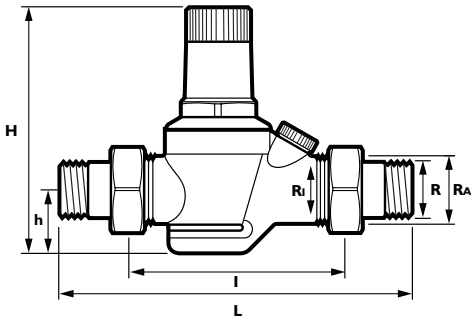

Connection size	R	1/2"	3/4"	1"
	RI	1/2"	3/4"	—
	RA	3/4V	1"	1 1/4"
Nominal size	DN	15	20	25
Weight approx. (kg)		0.65	0.82	1.35
Dimensions (mm)				
	L	150	168	186
	I	90	100	107
	H	122	122	122
	h	33	33	33
kvs-value		2.6	2.8	3.0

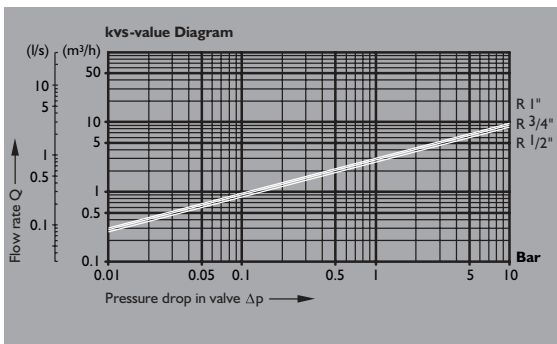

Data

Maximum pressure	— 16.Bar
Outlet control pressure	— 1.5–6 Bar
Factory setting	— 4 Bar
Minimum pressure drop	— 1 Bar
Max. operating temperature	— 70°C

Product	DN	Connection
PRV05	15	1/2" BSP(M)
PRV05	20	3/4" BSP(M)
PRV05	25	1" BSP(M)
Pressure gauge (Not Included)		1/4" BSP(M)

Materials

Body	— Dezincification resistant brass
Cover	— High quality synthetic material
Diaphragm	— Fibre reinforced NBR
Spring Adjustment	— Stainless steel
Valve Insert	— High quality synthetic material
Seals	— NBR
Filter	— Stainless steel mesh
WFBS Listed	

Code numbers

850215	— 1/2" PRV05 pressure reducing valve.
850220	— 3/4" PRV05 pressure reducing valve.
850225	— 1" PRV05 pressure reducing valve.
811000	— 1/4" BSP pressure gauge.

Application

PRV05 can be used for domestic, industrial or commercial applications and protects water installations from excessive pressures from the water supply. The PRV05 range offers a high quality solution where the set pressure is maintained even where there is a wide inlet pressure fluctuation. Installing PRV's will prevent pressurisation damage, reduce water consumption and minimise flow noise. It is recommended that a Douglas Keysafe isolating ball valve strainer is used to protect the PRV.

Special features include

- Simple outlet pressure adjustment by green control cap.
- Set pressure is directly indicated on the set point scale.
- Inlet pressure balanced - no influence on outlet pressure.
- Low maintenance - adjustment spring is not in contact with the potable water
- Low maintenance - replaceable valve insert.

How to specify

Douglas 1/2" PRV05 pressure reducing valve. Control range 1.5 - 6.0 Bar. Code no. 850215

Douglas 3/4" PRV05 pressure reducing valve. Control range 1.5 - 6.0 Bar. Code no. 850220

Douglas 1" PRV05 pressure reducing valve. Control range 1.5 - 6.0 Bar. Code no. 850225

1/4" BSP pressure gauge. Code no. 811000