

### Tempostop exposed push button control

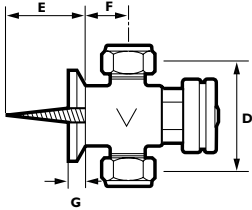

**15 second**  
**D.** 62mm  
**E.** 41mm  
**F.** 27mm  
**G.** 7mm

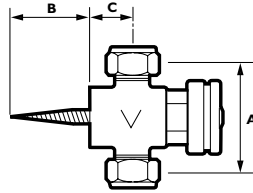

**30 second**  
**A.** 97mm  
**B.** 42mm  
**C.** 30mm

### Tempostop recessed push button control

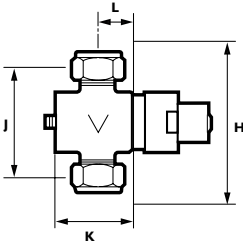

**15 second**  
**H.** 90mm  
**J.** 62mm  
**K.** 48mm  
**L.** 23mm

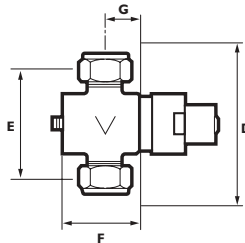

**30 second**  
**D.** 130mm  
**E.** 95mm  
**F.** 55mm  
**G.** 25mm

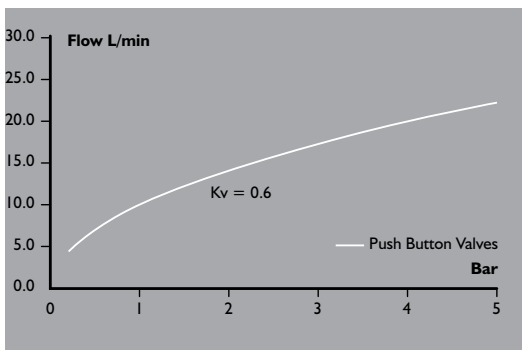

### Data

Maximum temperature – 80° C  
 Recommended pressure – 0.3 to 5.0 Bar  
 Maximum pressure – 10 Bar  
 15 sec time delay. (+5 sec / -5 sec Nominal)  
 30 sec time delay. (+5 sec / -10 sec Nominal)  
 Connections – 15mm / 1/2" BSP(M).  
 Cartridge and spares kit available.

### Materials

Body – Brass (*chrome plate finish*)  
 Knobs – Polished chrome  
 Valve – Plastic (*hostaform*)  
 'O' Rings – EDPM rubber

### Code numbers

747116 - Tempostop exposed, 15 sec ( $\pm 5$  secs).  
 747922 - Tempostop recessed, 15 sec ( $\pm 5$  secs).  
 749725 - Tempostop exposed, 30 sec (+5 / -10 secs).  
 749187 - Tempostop recessed, 30 sec (+5 / -10 secs).

### Application

Tempostop push button taps and valves conform to the highest standards and are specifically designed for use in a wide range of applications. They are precision engineered to provide effective timed control for water flow.

They are easy to use and the push button valves are preset to 8 L/min and flow rates are fully adjustable on site.

Tempostop should be used in conjunction with a thermostatic mixing valve to provide safe water temperature control.

A circular wall plate is available for heavy duty use.  
 Code no. 824800

### How to specify

Tempostop exposed time flow control 15 sec nom.  
 Code no. 747116

Tempostop recessed time flow control 15 sec nom.  
 Code no. 747922

Tempostop exposed time flow control 30 sec nom.  
 Code no. 749725

Tempostop recessed time flow control 30 sec nom.  
 Code no. 749187

Heavy duty wall plate. Code no. 824800

### Heavy duty wall plate

